

BYBERRY WALTONS

AN ACCOUNT OF FOUR ENGLISH BROTHERS  
NATHANIEL & THOMAS & DANIEL & WILLIAM WALTON

WHO SETTLED ABOUT 1683  
IN  
BYBERRY TOWNSHIP  
PHILADELPHIA COUNTY  
PENNSYLVANIA

WITH ACCOUNTS OF MORE THAN 4000 WALTONS  
AND  
MANY MORE BY OTHER SURNAMES  
DESCENDED FROM  
THESE FOUR BROTHERS

COMPILED BY  
NORMAN WALTON SWAYNE  
GREAT-GREAT-GREAT-GREAT-GREAT-GRANDSON  
OF THE ABOVE 4 DANIEL WALTON

AS A MEMORIAL TO HIS MOTHER  
2396 MARY DENT WALTON SWAYNE

FIRST EDITION

PRINTED BY  
STEPHENSON - BROTHERS  
PHILADELPHIA PENNSYLVANIA  
1958

\*\*\*\*\*

FIRST GENERATION

\*\*\*\*\*

1 WILLIAM WALTON (1), baptized 19 Aug. 1629 in the parish of Oxhill, Warwickshire, England, married 30 Sep. 1657 Alice Martin. This is from Ms of Alfred R. Justice, whose search in England found that William's father was Thomas of Oxhill, baptized there 20 Apr. 1602, this Thomas' father was William of Oxhill, and this William's father was Thomas of Oxhill, will proved Oct. 1593, married Elizabeth. This carries the line three generations back of 1 William Walton (1) to his great grandfather. However, in this compilation he is given the number one and is called the first American Walton of his line, despite the belief that he never came to America. This allows the descendants of his four sons who did come, to be shown as one family. The Friend, Vol. 28, page 381, says the place of nativity of the four sons was in the parish of Byberry in the southeast corner of Gloucestershire. So William, their father, evidently lived there, some distance southward from his place of baptism, for a considerable time. William Walton, together with Joseph Hunt of Stratford upon Avon and William Hunt of Radway, all in the county of Warwick, purchased from Edward Byllynge of London by lease and release 22 and 23 Sep. 1682, one tenth of a propriety of land in West New Jersey, a propriety being one hundredth of the province. William devised his interest in West Jersey to sons Nathaniel, Daniel, Thomas and William. The 1704 deed recorded in Gloucester Co., N. J. by which these four, residents of Phila. Co., Pa., conveyed this for 30 pounds to John Hugg of Gloucester Co., shows it was 100 acres adjoining land formerly surveyed to William Hunt, lying at the head of the town bounds of Gloucester and then in possession of Jacob Clements. The four sons of William arrived in America probably about 1683, and soon after settled in Byberry Twp in Phila. Co. It has been published and frequently copied, that they arrived in 1675, but confirmation seems to be lacking. The belief that they did not arrive until about 1683, has come from the many documentary occurrences of their names soon after that time, but none before, and particularly from a letter the eldest, Nathaniel, wrote in 1713 to his brother William, the youngest. An account of this is in Isaac Comly's History of Byberry, prepared 1827: "Nathaniel in a letter which he wrote to his brother William, dated 'Bybury ye 7th of October 1713' says he paid for William's passage to this country, five pounds sterling; that he laboured hard for this money in Old England at a groat a day; that the principal and compound interest which he had forborne thirty years and upwards, had come almost to 200 pounds of old currency; that William had got him nothing, but might see he had made a man of him to that very day; and that he most certainly expected him to pay some way or other to his content; not, he adds, because he could not do without it, for, he blessed God, he had plenty of everything, but because it was his due, and William was able to pay it." At the time of this William's ten children had begun to marry. William then had been many years the principal preacher in Byberry Mtg, and without doubt was a respected citizen. 1st of 10th mo 1688 each of the four sons made his first recorded purchase of land, when each was deeded by Thomas Fairman of Shackamaxon for ten pounds, 100 acres of a 500 acres tract rec'd by Thomas in 1784 from William Penn. When plotted from the deeds it is evident these 400 acres comprised the southwestern four fifths of the tract on Thomas Holme's map of 1681 marked Robert Fairman. They lay in Byberry Twp along its northwestern boundary, next to Moreland Twp. Lines between the lands of the four brothers were almost parallel with each other and nearly at right angles to the Moreland line. The tracts were laid out in the order of age, Nathaniel's on the southwest, 100 to 103 perches in width, 140 to 190 perches in length, Thomas' next to the northeast, 77 to 75 perches wide, 190 to 220 perches long, Daniel's next to

the northeast, 73 to 70 perches wide, 220 to 233 perches long, William's last to the northeast, 68 to 66 perches wide, 233 to 246 perches long, bounded on his northeast by other land of Thomas Fairman. This tract of 400 acres is in the form of a pointless wedge, running from a width of 140 rods on the southwest boundary of Nathaniel's land to a width of 246 rods on the northeast boundary of William's land, with a total length of 318 rods along Moreland Twp. The History of Byberry and Moreland says "They arrived at New Castle early in 1675, provided with axes, hoes, etc., ready for making a settlement in the wilderness. From there they proceeded up the Delaware in search of a place for a settlement, carrying their whole stock of utensils, provisions, etc. on their backs. After some time spent in examining the country they arrived at the Poquessing Creek, and were so highly pleased with the level land in that vicinity, the abundance of good water, and the beautiful appearance of the country, that they determined upon making a settlement near the banks of that stream. Having neither the time nor the means for erecting a dwelling they dug a cave and covered it with bark and dirt. Therein they lived several months while they prepared the soil for crops. Not having any wheat two of the brothers, in the latter part of the same summer, walked to New Castle to procure a bushel of it. Shouldering half a bushel each, they carried it home, a distance of nearly fifty miles. For want of other implements the soil was prepared with hoes, and so well was the job done that they are said to have reaped sixty bushels at the next harvest. This was probably the first wheat ever raised in Byberry Twp." The only known children of William Walton & Alice Martin were these four sons, from whom it seems likely most of the Waltons in the vicinity of Phila. have descended. The name has become common in that city and in the surrounding counties of Phila., Bucks, Montgomery and Chester. Some Walton descendants have crossed the Delaware into New Jersey, some have gone further north and west in Pennsylvania, a few south into Virginia, many from these last two states into Ohio, some on their way further west. They have scattered thinly throughout the United States and Canada. However, not nearly all Waltons in America have come from these Byberry settlers. The name has long been common in England, and Walton emigrants from there became immigrants into New England, New York, Virginia and probably elsewhere, some before the Byberry Waltons. Many have continued to arrive since, so even around Phila. many white Waltons are not of Byberry descent. These four are called the second generation:

- 2 Nathaniel b ab 1656 d 1733 m 1685 Martha Bownall or Bownel or Bowling  
b ab 1663 d 1741
- 3 Thomas b ab 1658 d 1758 m 1st 1690 Priscilla Hunn, m 2nd 1736 Elizabeth Eastburn b 1695
- 4 Daniel b ab 1660 d 1719 m 1688 Mary Lamb
- 5 William b ab 1662 d 1736 m 1689 Sarah Howell d 1749

\*\*\*\*\*

## SECOND GENERATION

\*\*\*\*\*

2 NATHANIEL WALTON (2), born about 1656, died 31 March 1733 aged 77, son of 1 William Walton & Alice Martin of Oxhill, County of Warwick, England, married 12th mo 10th 1685 in Phila. under care of Phila. Mtg, Martha Bownall or Bownel or Bowling of there, born about 1663, died 15 Sep. 1741 aged 78. These records are from Trinity Oxford Church, as copied in the Mervine Collection, which has also the marriage of daughter Lydia. Abington Mtg, held that day at Buyberry, says 26th of 11th mo 1685 Nathaniel to Phila. "in order to Marriage with Martha Bownel of Philadelphia." Phila. Mtg says 12.1.1685 Nathaniel Walton to marry Martha Bowling. The Gilbert Cope Collection says the date of the marriage certificate was 12.10.1685/6. American Marriage Records Before 1699, by Clemens, gives this marriage 1 Dec. 1685. Probably this was

the result of two errors, one in style, the other in taking the date of the meeting minute for that of the wedding. Likely Feb. 10, 1685 is right. Nathaniel & Martha seem to have spent their lives in Byberry Twp, at least until his death. In 1691 at the time of the Keithian Separation among Friends, Byberry Mtg went Keithian. Nathaniel remained there, although his three brothers withdrew with those who met at the house of Henry English. The Keithian Mtg at Byberry seems to have broken up after two or three years, when its members joined Episcopalians, All Saints, Quaker Baptists and other denominations. Thus it has been easier to trace the descendants of the other three than those of Nathaniel, because the early Friends' records give a pretty fair start on those of the three who remained Friends. An article in The Friend, Vol. 28, page 381, says Nathaniel, eldest of the four brothers, probably was not far from 30 in 1682. It relates that Nathaniel, after the Keithian defection, once attended the other meeting, and when one of his brothers was preaching became angry and interrupted with "Brother, thou lyest." In addition to the 100 acres bought in 1688 from Thomas Fairman, Nathaniel received at least four other tracts in Byberry Twp and a large one in Bucks Co., all or part of which was later in Warwick Twp. 16th of 10th mo 1689 he rec'd by patent 100 acres, apparently part of the land of John Hart in the SW corner of Byberry Twp, but never patented to him; the .... day of .... mo 1691 he rec'd from Thomas fairman for ffour pounds 40 acres in the Twp of Bybury, bounded SE by Andrew Griscom, SW by Richard Collett, NW by a road threw Mooreland, NE by said Nathaniell Walton, no distances given; 1st day of 10th mo 1691 Thomas Ffairman appointed James Cooper his attorney to declare and deliver these presents as his act and deed; 4th day of 4th mo 1695 he rec'd from Sarah Griscomb for 42 pounds 16 shillings 239 acres in the Twp of Biberry, rec'd by will of husband Andrew Grescomb dated 4th day of 7th mo 1694, beginning at an Ash Tree, being corner of land that was John Harts now Nathaniel Waltons, standing by Poquessin Creek, NW & N by said Nathaniel Walton's land 403 perches, NE & by E by John Turner 98 perches, SE & by S by Daniel Jones 373 perches to Poquessin Creek, down the creek to the beginning; in 1695 or a little later he rec'd 48 acres in a narrow strip just upcreek from the last, by a deed from Daniel Jones to Thomas Prichard, assigned or endorsed by him to Anna Salter, by her to William Gage, and by him to Nathaniel Walton; 11 March 1718 he rec'd from Nathan Stanbury of Phila. for 225 pounds 500 acres in Bucks Co. by John Tatham and Benjamin Forley or Furley. This last he deeded Apr. 10, 1727 to sons Joseph and Benjamin, two contiguous tracts of 250 acres each, for five pounds each; May 27, 1732 he with wife Martha deeded to youngest son Malachi 107 acres, beginning at a corner stone, NE by N by John Rush's children 40 perches, SE by S 35 perches, NE by N 120 perches to line of Ellis, bounded on both the last courses by John DeGrift, SE by S 100 perches by Ellis, SW by S 160 perches by Nathaniel Walton's other land to line of James Rush's children, NW by N 130 perches by same and John Rush's children to the beginning, parts of three contiguous tracts in Bibury containing 385 acres in all, 100 acres patented 20 Sep. 1693 to William Markham, Robert Turner and John Goodform, 237 acres deeded 14 June 1695 by Sarah Griscom whose later husband John Kaighn confirmed this by his deed 26 Dec. 1698, 48 acres by assignment or endorsement of William Gage and others on a deed by Daniel Jones, who 12 Feb. 1685 deeded these 48 acres to Tho. Prichard; this began at Poquessing Creek and was part of 100 acres Jones had, running NW by W 800 perches by land of Ellis, SW by S 20 perches, SE by S by William Campian 800 perches to Poquessing Creek; John Turner's land was next up the creek and Jones had deeded him the other 52 acres; this deed to Malachi included the NW ends of the three tracts; except for one slight discrepancy in the length of one course, the description was the same as when Malachi in 1737 sold to Job Walton; it was witnessed by Nath'l Walton Junr and M. Davies, perhaps 2 Nathaniel's daughter Martha or her husband; it was recorded 1848. 27 Feb. 1734 Nathaniel Walton and Malachi Walton, yeomen of Bibury, exrs of Nathaniel, deeded to Benjamin Walton of same for 250 pounds, 150 acres, beginning at a post in the middle of Southampton Road which leads to Swift's Mill, a corner of Joseph Walton's land, thence along middle of road the



Lands of 2 Nathaniel Walton (2) with some owned by his three brothers

Scale: 1 mm to 6 perches

- A 100 acres rec'd 1688
- B 100 acres rec'd 1689 by patent
- C 40 acres rec'd 1691
- D 239 acres rec'd 1695
- E 48 acres rec'd 1695 or later
- F 100 acres deeded to son Malachi
- G 150 acres by exrs to son Joseph
- H 150 acres by exrs to son Benj.

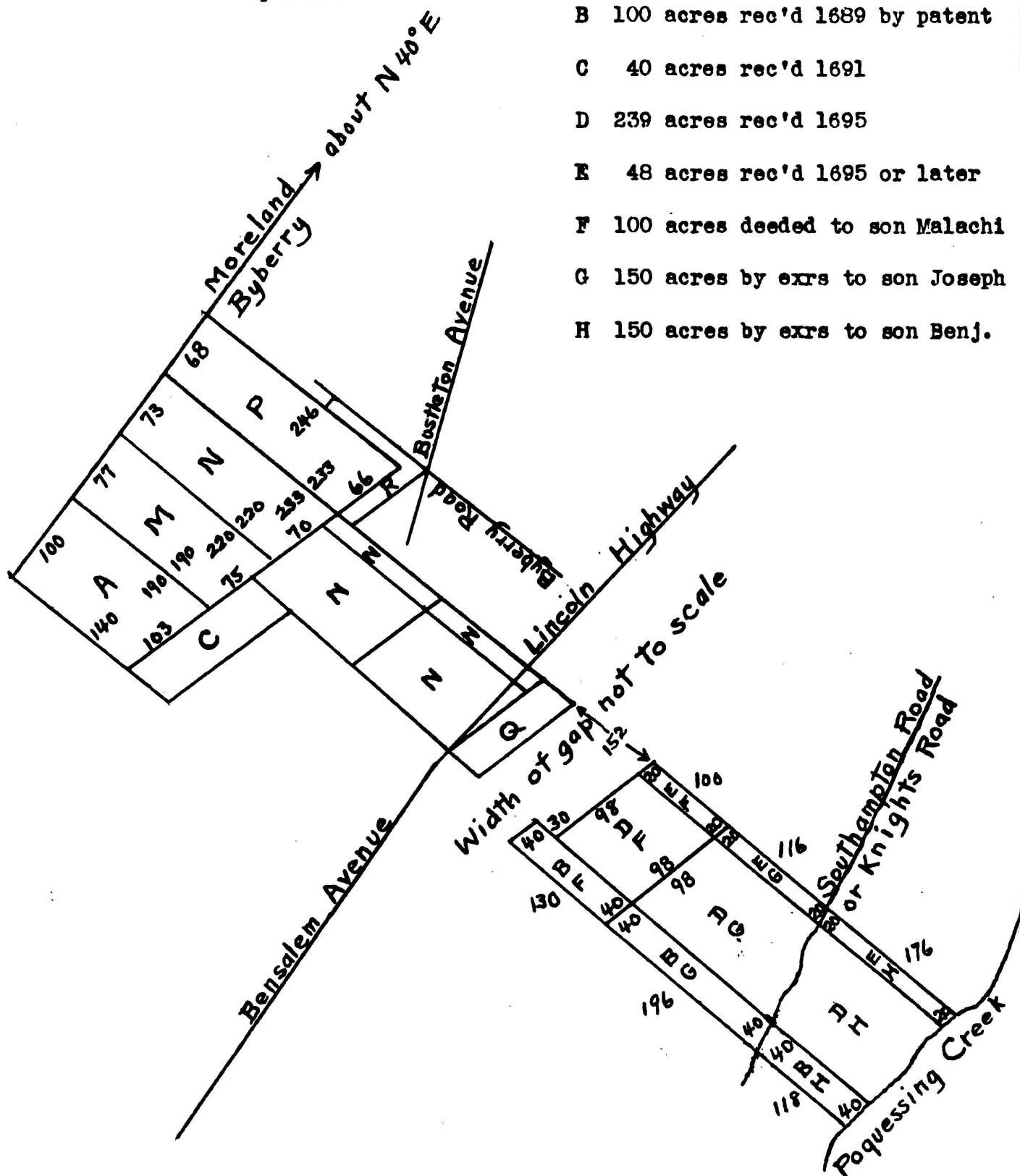

- M 100 acres brother Thomas deeded to brother Daniel
- N Other land of brother Daniel. See under 4 Daniel
- P Land of brother William. See under 5 William
- Q 30 acres rec'd 1734 by brother Daniel's son 26 Daniel
- R 11 acres deeded by brother William's son 33 Isaac

several courses dividing this from Joseph Walton to land late of Josiah Ellis dec'd, by same SE by S 176 perches to Potquessing Creek, down creek the Several Courses to Evan Thomas, by same NE by N 118 perches to the beginning; this too included parts of three tracts, 239 acres which was part of 495 acres patented to Andrew Griscom, whose widow Sarah Griscom 14th of 4th mo 1695 deeded the 239 acres to Nathaniel, 48 acres which was part of 100 acres of Daniel Jones, who 2nd Feb. 1685 deeded the 48 acres to Thomas Prichard, who granted it to Anna Salter, who granted it to William Gage, who granted it to Nathaniel, and 100 acres patented 16th of 10th mo 1689 to Nathaniel; this piece now granted taketh in the ends next Potquessink Creek of the above three tracts; witnesses were two Joseph Waltons, one of them of Warwick; about two and a half months previous, 12 Dec. 1734, the same exrs had deeded to Joseph Walton of Warwick Twp, yeoman, for 150 pounds, 150 acres, being half of what Nathaniel held when he died, beginning at a road from Southampton Twp to Swift's Mill on Poetqusink Creek called Southampton Road and in line of John Jackson, by this and John Rush's NW by N 196 perches to a corner of Malachi Walton, NE by N 160 perches to a corner in line of Ellis, also another corner of Malachi Walton, by Ellis SE by S 116 perches to the afd Road, by Severall Courses of the s'd Road to the beginning; this included the midsections of the same three tracts as in the two deeds next above. The exrs stated Nathaniel had 287 acres in Ribury Twp when he died, having granted Malachi 100 acres out of 387. Many discrepancies occur among these three deeds, not only in spelling, but also in dates and acreage. What became of the 140 acres Nathaniel owned on the Moreland boundary of Byberry has not been discovered. Possibly that tract went to son Nathaniel by an unrecorded deed. The other 387 acres had become 407 by the above three deeds to Malachi, Joseph and Benjamin. William Penn allowed seven acres for roads with each 100 acres patented. Later the deeds went to the middles of roads, which were included in the computation of acreage. At one time on a straight line from Poquessing Creek to Moreland Twp 808 perches bounded Daniel Jones and 233 bounded 4 Daniel Walton. As Daniel bought toward the creek, Nathaniel bought toward Moreland, thus by 1734 there remained but 152 perches on that line across Byberry Twp between Daniel's son 26 Daniel and Nathaniel's son 9 Malachi. When Nathaniel drew his will, Sep. 19, 1732, he said he still had 287 acres in Byberry. The will was proved in Phila. Apr. 4, 1733. Martha's will, drawn Feb. 10, 1736, then of Phila., proved there Sep. 25, 1741, taken with his, gives the only list found of these ten children and clues to the mates of some:

- 6 Benjamin d 1737 m Elizabeth, alive 1737
- 7 Joseph d prob. 1759 m Sarah, prob. Roberts, alive 1776
- 8 Nathaniel, alive 1736
- 9 Malachi d between 1745 and 1754 m by 1737 Mary Gandonett d prob. between 1768 and 1772
- 10 Mary, alive 1736, m by 1726 John Addis d by 1746
- 11 Elizabeth, alive 1736, m by then James Waterman
- 12 Esther, alive 1736, m by then Joseph Roberts
- 13 Margaret, alive 1736, m by then John Powell
- 14 Martha, alive 1732, d prob. by 1736, m by 1732 a Davids
- 15 Lydia, alive 1732, d prob. by 1736, m 1732 or later John Roberts

3 THOMAS WALTON (2), born about 1658, died 2.4.1758, son of 1 William Walton & Alice Martin of Oxhill, County of Warwick, England, married 1st probably very early in 1690 Priscilla Hunn, daughter of Priscilla, who as widow Hunn had before 1687 married George Bowers, then of Kent Co., Del. Thomas married early in 1736, possibly 2nd, Elizabeth Eastburn, born 1.16.1695, died probably 5.6.1777, daughter of John Eastburn & Elizabeth Jones of Southampton Twp, Bucks Co., Pa. Both marriages are from meeting records. Abington Mtg says 24th of 12th mo 1689 Thomas to Phila. in order to proceed on in Marriage with Prissilla Hunn of Phila.; Phila. Mtg says 12.29.1689 Thomas to marry Priscilla Hun. Abington Mtg says 2.26.1736 Thomas Walton & Elizabeth Eastburn having declared intentions before two meetings, are at liberty to accomplish their mar-

this William was son of Thomas' son James, and after death of his father 20 James, perhaps when his mother married again in 1745, lived with his grandfather 3 Thomas, which may have started an erroneous tradition. Concerning this doubt, the following evidence appears: At the time of the later marriage mentioned above, 3 Thomas was about 77 and his new wife Elizabeth Eastburn a 41 years old spinster from a neighboring farm. The will of Elizabeth's mother, drawn June 10, 1739, said Elizabeth was wife of Thomas Walton and left her 28 pounds, but if she die without issue before the end of four years son John may keep the unpaid balance except five shillings to Thomas Walton. Also to daughter Elizabeth Walton a little oak desk. In 1755 this same Elizabeth Walton was willed five pounds by her uncle Robert Eastburn and in 1774, 30 pounds by her brother John Eastburn. 24 May 1746 Thomas Walton of Mannor of Moreland, County of Phila., Yeoman, & wife Elizabeth, with other heirs of John Eastburn the elder, for divers good causes and considerations released to eldest son John Eastburn of Southampton Twp, clockmaker, 206 acres, and to son Thomas Eastburn of same 100 acres. As to the possibility of 16 Thomas having been the one who married Elizabeth Eastburn, the 1777 will of 54 Nathaniel Walton, drawn the same year as the death of 16 Thomas, said he expected to inherit, as eldest son of the eldest brother of 16 Thomas. The existence then of William and of several of William's children would have prevented such expectation, had William been son of 16 Thomas. This confirms the History of Byberry and Moreland statement that 16 Thomas was not married. It seems just possible William was son of 3 Thomas by a wife who came between Priscilla and Elizabeth. Besides Thomas, John and James, known to have been sons of 3 Thomas, four others, Caleb, Joseph, Mary and David, are believed to have been his children, from their times, places and connections, since it is believed we have complete lists of children of Thomas' three brothers, and no other contemporary nearby Walton family has been found, save one in Phila. in which the name soon became extinct. Below these seven are Elizabeth and William, possible but considered not probable:

- 16 Thomas b ab 1693 d 1777
- 17 Caleb, alive 1734
- 18 John, alive 1740
- 19 Joseph d ab 1733 m 1730 Marey Coney or Marcy Corry
- 20 James d before 1745 m 1730 Mary Jeanes
- 21 Mary prob. m 1733 Michael Hilton
- 22 David d 1768
- 23 Elizabeth d 5.6.1777, more likely widow of 3 Thomas NFM
- 24 William b ab 1735 d ab 1783 m by 1758 Elizabeth Wells. More  
likely grandson. Hereafter mentioned only as 61 William son  
of 20 James NFM

4 DANIEL WALTON (2), born about 1660, died 2nd mo 20, 1719 aged about 60 years, son of 1 William Walton & Alice Martin of Oxhill, County of Warwick, England, married probably in August, 1688, Mary Lamb, who probably survived him. Abington Mtg minutes 21st of 6th mo 1688 say the marriage had taken place. Both Isaac Comly's obituary notes and the meeting records give the above date of death, and the latter say he was buried at John Harts at Bybury on ye Creek Poequesy. Daniel seems to have lived all his life after 1683 in Byberry, on property which in 1956 lay at the intersection of Roosevelt Boulevard (part of Lincoln Highway) and Comly Road. The following deed of 10 May 1755 shows he had been a trustee of Byberry Mtg, a subsidiary of Abington Mtg, from whose minutes it appears Daniel was always in good standing: Daniel Walton and Joshua Walton (two of the sons of Daniel Walton late of Biberry Township deceased), Richard Walton (son & heir of Joseph Walton deceased, another son of Daniel Walton the father), Daniel Walton, Benjamin Walton, William Walton, Hannah Walton, Rebecca Walton, Sarah Walton, Esther Walton, children of Benjamin Walton deceased (another son of said Daniel Walton the father), William Homer & Mary his wife (daughter of said Daniel Walton the father) deeded to several trustees of Biberry Meeting for five shillings one acre rec'd 2nd of 1st mo (March) 1694

## Lands of 4 Daniel Walton (2)

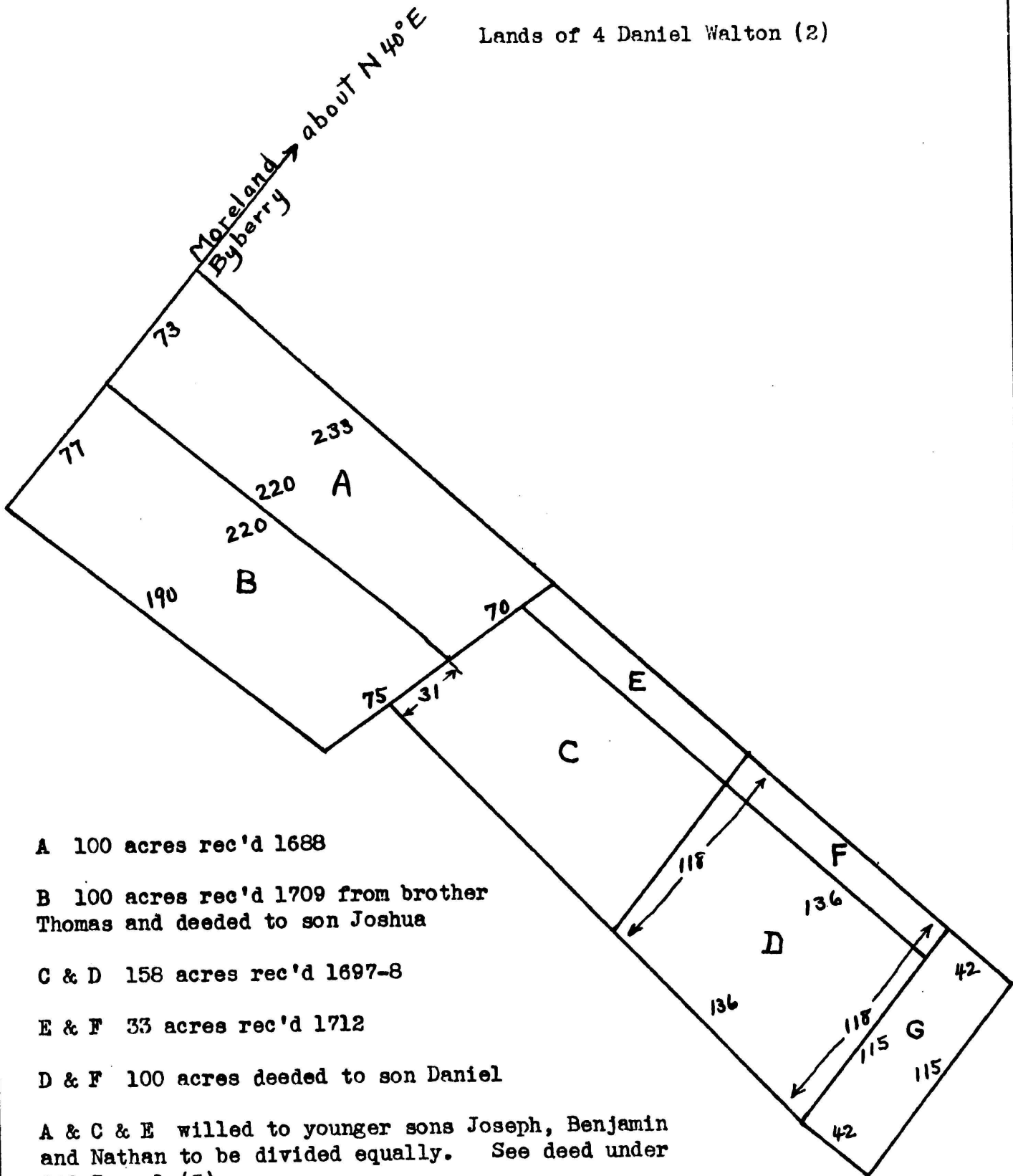

A 100 acres rec'd 1688

B 100 acres rec'd 1709 from brother Thomas and deeded to son Joshua

C & D 158 acres rec'd 1697-8

E & F 33 acres rec'd 1712

D & F 100 acres deeded to son Daniel

A & C & E willed to younger sons Joseph, Benjamin and Nathan to be divided equally. See deed under 240 Israel (5)

G 30 acres rec'd 1734 by Daniel's son 26 Daniel

Scale: 1 mm to 3 perches



by Daniel Walton & Henry Carver from Henry English to the use of the people of God called Quakers for a Burying place. It has ever since been so used and a Meeting House erected on it. The rest of Daniel's descendants are either dead without issue intestate or out of Unity with the Religious Fellowship of Friends. An article in The Friend, Vol. 28, page 381, says Daniel is believed to have come forth in the ministry soon after the defection of George Keith, that he was often representative to the quarterly meeting of ministers, performed other services, and that in 1711 with brother William had liberty from Friends to visit in gospel love the lower parts of this province and territories and attending the general meeting, also that when he died Daniel was about 60. In 1693 as tax collector of Byberry he assessed his brother Nathaniel at 31 pounds, tax 2s 6d, brother Thomas at 30 pounds, tax 2s 6d, himself the same as Thomas, brother William at 50 pounds, tax 4s 2d. Besides the 100 acres in 1688 from Thomas Fairman, he acquired at least three other tracts, all contiguous: 1st 158 acres from John Kaighin & wife Sarah in 1697/8, 2nd 33 acres from John Swift in 1712 for 33 pounds, 3rd 100 acres Oct. 14, 1709 from brother Thomas, which Thomas had rec'd 10.1.1688 from Thomas Fairman. For this Daniel paid 140 pounds and assumed the yearly quitrent to the Lord of the Fee. July 1, 1717 Daniel & Mary deeded to their 3rd son Joshua for only 28 pounds, love and affection, the 100 acres rec'd from brother Thomas. The following month, 4th of 6th mo 1717, they deeded to son Daniel without price 100 acres, beginning at a corner in the line of Richard Collett, NW by N by Collett 136 perches, NE by E by my land 118 perches, SE by S by Josias Ellis 136 perches, SW by W by John Swift 118 perches to the beginning, rec'd in two lots, 1st from John Kaighin & wife Sarah sole extrx of Andrew Griscom her former husband who had by patent 495 acres and I bought 158 of that, 2nd 33 acres from John Swift, part of 50 acres formerly of John Turner. This deed was proved 1767 by witness John Clifton and recorded 1773, at the same time as a deed to the same grantee for land adjacent. See under him. Daniel Walton and Nathan Walton, probably this one with his very young son, were witnesses 8.24.1705 at the marriage at Phila. Mtg House of Jedidiah Hussey of New Castle Co. & Esther Cooper of Phila. The will of Daniel Wallton of Township of Bibery, drawn 1.19.1718, proved in Phila. Apr. 25, 1719, being in health, said: In considering my eldest son Samuel Wallton and his disobedience and undutifullness to me and to his mother and also his extravagant Life whearby I have been forced to pay Severall Soms of money to discharge his debts which doth amount to Such a Som or to so great a part of my Estate as I do think fitt to be his portion thearfore I do give him One English Shilling and no more. The 100 acres formerly granted to son Daniel Wallton was confirmed to him and wife Elizabeth and he was willed One Silver English Shilling. Son Joshua Wallton who was formerly granted 100 acres was willed One Silver English Shilling. Three younger sons, Joseph, Benjamin and Nathan were to divide equally all the real estate, each coming into his portion at the age of 21, until which time they were to continue in subjection to their mother and be diligent in the plantation under her. Of the personal estate one third was to go to wife Mary exr, two thirds to be equally divided among Joseph, Benjamin and Nathan except two good cows and 15 pounds to dafter Mary Walton when she became 16. Most data for these seven children did not get into the meeting records, so have come from the History of Byberry and Moreland. Most births are guesses. That history says Benjamin was born about 1693, but his father's will shows that was much too early:

- 25 Samuel b ab 1689 d ab 1758 m 1709 Marcy Waterman alive 1758
- 26 Daniel b ab 1691 d 1757 m 1714 Elizabeth Clifton alive 1757
- 27 Joshua b ab 1693 d 1759 m 1716 Catherine Albertson d 1759
- 28 Joseph b ab 1698 d 1727 m 1722 Esther Carver
- 29 Benjamin b 1701 d 1753 m 1724 Rebecca Homer b 1704 d 1783
- 30 Nathan b ab 1703 d minor, not married
- 31 Mary b ab 1708 d 1788 m 1732 William Homer b 1707 d 1786

5 WILLIAM WALTON (2), born about 1662, died 12th mo 9th 1736,

son of 1 William Walton & Alice Martin of Oxhill, County of Warwick, England, married 4.20.1689 Old Style, Sarah Howell, died 1749, probably in September. His birth is from The Friend, Vol. 29, page 380, which says he was born 1661 or 1662 in Byberry, Gloucestershire. His death and marriage are from the History of Byberry and Moreland. 24th of 4th mo 1689 Abington Mtg minutes say this marriage had taken place. The above history says William was the first preacher at Byberry Mtg after the Keithian separation in 1691 and was the principal one for the next forty years. A letter to him from brother Nathaniel demanding reimbursement for his passage money to America from England is under Nathaniel. A religious visit in 1711 in company with brother Daniel has been mentioned under Daniel. In 1711 William visited all the families of Byberry Mtg. In 1721 with Richard Busby he made a religious visit to Maryland, Virginia and Carolina. In 1723 he again visited all Byberry Mtg families, this time in company with Henry Comly. At the time of his death he was in the island of Tortola on a religious journey. His will, drawn Apr. 13, 1734, proved in Phila. Feb. 26, 1736, gave son Abel 100 acres in Moreland next where I now dwell, and son William 100 acres in Buyberry where I now dwell. Sarah's will, drawn Aug. 6, 1749, named William Duncan exr, but he renounced and letters were issued in Phila. to Thomas Mardon, father of Rachel and Mary Mardon, legatees. Besides granddaughters Mary and Rachel Mardon, were named daughter Sarah and her daughter Sarah, son Isaac and his sons William and Joseph. A witness was Benjamin Walton. The 100 acres granted to William 1st day 10th mo 1688 by Thomas Ffairman for ten pounds, next Daniel Ellis, Daniel Walton and Land called Moreland, rec'd 1684 by Ffairman from William Penn, were the 150 acres willed to son William exr. The dimensions given might enclose about 107 acres. June 20, 1695 William bought 100 acres from John Holme for ten pounds. This was next his other land, but across the line in Moreland Twp, and was the tract willed to son Abel. Apr. 7, 1711 William bought for 222 pounds from William Allen of Phila., another extensive land speculator like Fairman, 555 acres in Moreland Twp, about four miles NW from his properties on the line. Allen had recently bought this from Nicholas Moore & wife Priscilla, it being part of 9815 acres rec'd in 1684 from William Penn by Nicholas Moore, father of the grantor. When Allen bought this the boundaries were: Beginning in line of Peter Chamberlin, SE 92 perches, SW 117½ perches, SE 242 perches, SW 235 perches to a small brook running into Potquessink Creek, NW by Thomas Shute 332 perches to land of Lawrence Tomson, NE by same 352½ perches to the beginning. The deed from Allen to William Walton has the same bearings and names, except that Tomson has become Thompson. However, SE 242 perches has become 235 perches, SW 235 perches has become 230 perches and NE 352½ perches has become 343 perches. The NW strip of this, 200 acres that William & Sarah deeded Jan. 21, 1715 to Isaac, eldest son and heir apparent, lay on both sides of York Road, laid out in 1711, and included the business section of Hatboro where it developed later, on both sides of the main street, from Mill Road to past Byberry Road, neither then opened. All this Isaac got for 20 pounds, love and affection. The remainder, 355 acres, deeded the same year by William & Sarah to son Jeremiah, was nearly square, on both sides of Pennypack Creek for its whole NW to SE depth, SE of the SW two thirds of Isaac's part, York Road cutting through its western point. When William Penn wrote in 1708 to James Logan, he instructed him to have William Walton "keep all in order till we come." While 5 William lived several miles downriver from Pennsbury, he was presumably the man to whom the care of Penn's Manor House had been entrusted, since he is the only one of the name known to have lived nearby at the time, save for his son, born 1701. Penn never was able to return. For the ten children the reliability and completeness of data are more nearly satisfactory than for the children of William's three brothers. They lived close to Byberry Mtg, were members, and many of their dates got into the records. Some data have come from the History of Byberry and Moreland, Kirk Gen., Phila. wills and deeds and the Ms of Joseph Solomon Walton:

32 Rachel b 1690 d 1718 m 1714 Edward Parry d 1726

33 Isaac b 1692 d 1755 m 1st 1713 Mary Parry, m 2nd 1728 Sarah Kennet,

- m 3rd 1737 Sarah Holt d prob. 1795
- 34 Jeremiah b 1694 d 1740 m 1719 Elizabeth Walmsley b 1699 d 1787
- 35 Jacob b 1697 prob. d young
- 36 Sarah b 1699 m 1724 Benjamin Albertson
- 37 William b 1701 d 1740 not married
- 38 Abel b 1703 d 1771 m 1731 Rebecca Walmsley d 1775
- 39 Job b 1706 d 1784 m 1st 1728 Agnes Walmsley d by 1755, m 2nd 1757 Catharine McVaugh d prob. 1800
- 40 Hannah b 1708 d 1741 m 1st 1728 Thomas Walmsley d 1728, m 2nd ab 1730 Thomas Mardon
- 41 Mary b 1710 d ab 1732 m 1729 William Homer b 1707 d 1786

\*\*\*\*\*

### THIRD GENERATION

\*\*\*\*\*

6 BENJAMIN WALTON (3), died 1737, son of 2 Nathaniel Walton & Martha Bownall of Byberry Twp, Phila. Co., Pa., married Elizabeth. His will, drawn July 6, 1737, proved in Phila. Sep. 24, 1737, named mother Martha, wife Elizabeth extrx, brother Nathaniel and the four children below. Wife Elizabeth was to have the plantation in Bibury where I now dwell until son Benjamin is 21, he to have it then, and if he die sooner, then to son Nathaniel. This place had been deeded to Benjamin Feb. 27, 1734 by brothers Nathaniel and Malachi, exrs of the will of their father. Benjamin had rec'd also from his father Apr. 10, 1727 for five pounds, 250 acres in Bucks Co., probably in Warwick Twp. The four children:

- 42 Elizabeth
- 43 Martha
- 44 Benjamin m 1756 Catherine Williamson
- 45 Nathaniel

7 JOSEPH WALTON (3), died 10th mo 4th 1759, son of 2 Nathaniel Walton & Martha Bownall of Byberry Twp, Phila. Co., Pa., married Sarah, probably Roberts, alive 1776. His death is from Isaac Comly's obituary notes, Joseph Sr son of Nathaniel, and the History of Byberry and Moreland, which, however, says he was son of 8 Nathaniel, brother of 7 Joseph, and that he taught 60 years. One of these sources must have the wrong Joseph. Son Joseph of 7 Joseph is called schoolmaster in the 1764 deed below, and may have been the one who taught 60 years. Probably 7 Joseph was the one called son in law in the will of John Roberts of Abington, drawn Feb. 17, 1747, proved in Phila. March 12, 1747, who named wife Mary, daughters Alice, Ann, Patience and Rachel. Apr. 10, 1727 Joseph rec'd from his father 250 acres in Bucks Co. next Benjamin Walton. Apparently this was in Warwick Twp, for Dec. 12, 1734 when brothers Nathaniel and Malachi deeded Joseph 150 acres, he was of that township. Oct. 10, 1760 letters were granted to Joseph's sons Joseph and Boaz, both of Bibury. Nov. 8, 1764 these with the three other surviving children below deeded the 150 acres, now resurveyed as 161 acres, to son Joseph, who five days later, Nov. 13, 1764, with wife Barbara, deeded 70 acres of it to Boaz, and Apr. 6, 1776 Boaz & wife Mary deeded these 70 acres to Joseph Hallowell, at which time Sarah, mother of Boaz and relict of Joseph, was alive. These deeds were recorded March 15, 1841. From the above sources and from Trinity Oxford Church come data for these six children which allow a guess at their order:

- 46 Joseph b prob. around 1730 prob. alive 1790 m by 1764 Barbara, alive 1784
- 47 Sarah, alive 1774, m 1757 William Francis d 1774
- 48 Elizabeth, alive 1774, m 1st 1758 Samuel Dungan b ab 1734 d by 1774, m 2nd 1774 Elias Brown



probably dead by Apr. 13, 1734, when the former was drawn. A note in the Gilbert Cope Collection says Jacob, born 3.2.1697, son of William Walton & Sarah Howell, married Ann Roberts and Mary Holcomb. If so, Jacob was 43 at the time of the 1st marriage. There is considerable evidence that the Jacob who made these marriages was 5 William's grandson. See under 33 Isaac and 94 William.

36 SARAH WALTON (3), born 1st mo 28th 1699, daughter of 5 William Walton & Sarah Howell of Byberry Twp, Phila. Co., Pa., married 1724 Benjamin Albertson, son of William Albertson & Hannah Druit. This is from Abington Mtg, which says 8th mo 26th 1724 they passed meeting, 9th mo 30th 1724 were reported married, and Colonial and Revolutionary Families, Vol. VI, which mentions this marriage, names the parents of Benjamin and lists the first five children below. Sarah was not named in her father's 1734 will, but was named in the 1749 will of her mother, who called her Sarah Albertson and said she had a daughter Sarah. The six known children:

- 1 William, perhaps the William Walton Alberson, 3rd class, in 7th co., 1st Batt. Phila. Co. ab 1782
- 2 Jacob
- 3 Josiah b 1741 d 1827 m Ann Chew b 1741 d 1828
- 4 Benjamin
- 5 Chalkley
- 6 Sarah, alive 1749

37 WILLIAM WALTON (3), born 2nd mo 4th 1701, died 1740, son of 5 William Walton & Sarah Howell of Byberry Twp, Phila. Co., Pa., was not married and Dec. 12, 1740 letters in his estate were issued in Phila. to eldest brother Isaac, who inherited the part of the real estate devised to William by their father.

38 ABEL WALTON (3), born 10th mo 4th 1703, died 12th mo 15th 1771, son of 5 William Walton & Sarah Howell of Byberry Twp, Phila. Co., Pa., married 1731 Rebecca Walmsley, died 9.18.1775, daughter of Henry Walmsley & Mary Searl. They passed Abington Mtg 8th mo 25th 1731 and 10th mo 27th 1731 were reported married. Isaac Comly's obituary notes give her death. Letters in his estate were issued in Phila. Jan. 22, 1772 to Rebecca Walton and Henry Walton. The History of Byberry and Moreland says Abel lived near Somerton and died there 12th mo 25th 1771. This farm was in Moreland Twp on the edge of Byberry Twp, devised to Abel by his father. Abel Sr was on the tax list of Manor of Moreland 1769, 100 acres 2 horses 2 cattle tax 10.8.0. Only these four children have been found:

- 112 William b perhaps ab 1732 d 1780 m Mary Davis d prob. 1815
- 113 Mary m an Eastburn
- 114 Abel d 1803 m by 1758 Mary, prob. Vansant, d by 1817
- 115 Henry d 1794 m 1761 Rebecca Vansant d 1790

39 JOB WALTON (3), born 3rd mo 16th 1706, died 4.16.1784, son of 5 William Walton & Sarah Howell of Byberry Twp, Phila. Co., Pa., married 1st by 10th mo 30th 1728, when it was reported in Abington Mtg, Agnes Walmsley, died probably about the end of 1754, daughter of Thomas Walmsley & Mary Paxson, married 2nd June 29, 1757 at Swedes Church in Phila., Catherine McVaugh, died probably 11.1.1800, an aged woman. Feb. 8, 1755 letters in the estate of Agnes were issued in Phila. to husband Job. His will, drawn Dec. 23, 1779, proved in Phila. Apr. 29, 1784, named six of the eight known children, all but Isaac and Mary. The History of Byberry and Moreland says Job did some preaching in Byberry Mtg in 1752, also that he was reputed to have split 3600 rails in one week, the logs being cut off for him. Minutes of Abington Mtg 11.25.1754 say Byberry complains of Job Walton for drinking and taking it upon himself to preach while drunk. 12.30.1754 he requested forbearance. 11.24.1755 he still drinks to excess. One month later he was disowned and 1.26.1756 Job Sr had de-



clined to appeal and the testification was to be read at Byberry Mtg. The Joseph Solomon Walton Ms says Job was assessed in Byberry 1734 for 34 acres. Job Sr was taxed in Bibury Twp 1769 for 104 acres 4 horses 3 cattle tax 13.5.4, in 1774 (no Sr this time) 100 acres 3 horses 4 cattle tax 11.19.8, 1779 d tax 12. also 1779 d tax 3.0.0, 1780 valuation 2500 tax 62.10.0, 1782 valuation 522 tax 3.15.9, 1783 farmer 100 acres 2 horses 2 cattle. The births of these eight children are from Abington Mtg:

- 116 Isaac b 1729 d 1805 m 1771 Susannah Kirk b 1740 d 1821
- 117 Sarah b 1731 d 1804 m 1st 1753 Samuel Lloyd b 1729 d by 1783, m 2nd 1783 Jacob Tomkins b 1737 d 1810
- 118 Job b 1733 d 1807 m 1763 Margaret Powell d 1817
- 119 Isaiah b 1736 d 1791 m 1764 Sarah Pennington, alive 1803
- 120 Thomas b 1739 d 1807 m ab 1760 Esther Walton b 1738, both alive 1790
- 121 Mary b 1741 d prob. by 1779 m a Lloyd
- 122 William b 1742 d 1804 m 1st ab 1771 Mary Search, m 2nd Catherine d prob. 1810
- 123 Elijah b 1745 d 1803 m 1774 Rebecca Briggs b ab 1752 d 1844

40 HANNAH WALTON (3), born 2nd mo 9th 1708, died 3.11.1741, daughter of 5 William Walton & Sarah Howell of Byberry Twp, Phila. Co., Pa., married 1st 1728 Thomas Walmsley, died 6.30.1728, son of Thomas Walmsley & Mary Paxson, married 2nd about 1730 Thomas Mardon, died 1762. Hannah's death is from the Joseph Solomon Walton Ms, that of her 1st husband from the Walmsley Ms by William F. Corbit, which says Hannah had no issue by him, that of the 2nd from the proving of his will. Hannah with Thomas Wamsley Jr passed Abington Mtg 3rd mo 27th 1728 and their marriage was reported 4th mo 24th 1728. Thus her 1st husband was killed after two or three months, by a fall from his horse. Her 2nd was a tailor, "who had been purchased from off shipboard by George James," says the History of Byberry and Moreland, and since his time of servitude had not expired, Hannah bought the remainder. The will of Thomas Mardon of Byburry Twp, drawn 26 Apr. 1762, proved 3 May 1862 in Phila. by Richard Walton and Daniel Walton, two of three witnesses, the other being Joseph Walton, named eldest daughter Rachel Mardon, to have 50 pounds, daughter Mary Mardon to have 50 pounds, daughter Sarah wife of Jonathan Wilson to have 30 pounds and son Jacob exr to have all residue real and personal. Letters were issued to him the same day. In 1748 after Hannah's death Thomas deeded his land near Hatboro to Hannah's brother 33 Isaac Walton in exchange for equal acreage in Byberry Twp. See under Isaac. The same four children are in records of Abington Mtg:

- 1 Rachel b 1731 alive 1762 not married
- 2 Mary b 1734 alive 1762 not married
- 3 Jacob b 1737 alive 1762 not married
- 4 Sarah b 1739 alive 1762 m Jonathan Wilson, alive 1762

41 MARY WALTON (3), born 7th mo 15th 1710, died about 1732, daughter of 5 William Walton & Sarah Howell of Byberry Twp, Phila. Co., Pa., married probably in May 1729 William Homer, born 1707, died 1786. Mary with William Humer passed Abington Mtg 2nd mo 28th 1729 and 3rd mo 26th 1729 were reported married. Late in 1732 William married a first cousin of his 1st wife, 31 Mary Walton, and by her had eight children. William & the 1st Mary settled near Willow Grove and 100 years later descendants were living there. There were these two children:

- 1 Elizabeth b 4th mo 1730
- 2 William b 10th mo 3rd 1731 m by 1757 Elizabeth

\*\*\*\*\*

1771 were reported married. The History of Byberry and Moreland says he settled on York Road near county line and married Hannah, daughter of Benjamin Worthington. This marriage apparently was his son's. Probably this was the Isaac of Bucks Co. in the 1790 census with a family of one male over 16, one under 16 and three females. Isaac is on tax lists, Byberry 1769 no property, Warminster 1779, 105 acres 3 horses 6 cattle, 1781, 105 acres 2 horses 4 cattle, 1782, 105 acres 2 horses 5 cattle, 1783 tax 2.7.8, 1784, 105 acres eight whites one dwelling one outhouse, 1785, 105 acres 3 horses 3 cattle, 1786 tax 19.6, 1787 tax 1.0.11. 27 Jan. 1775 Isaac of Warminster, Yeoman, & wife Susannah deeded to Elijah Walton of same, Husbandman, for 400 pounds, 90 acres there rec'd 20 Oct. 1769 from Samuel Lloyd of same, Mason, & wife Sarah, for 361 pounds one shilling. This was recorded Apr. 6, 1842. The 1769 deed to Isaac of Byberry was recorded as dated 17 Oct. 1769. Other land was rec'd from the same Lloyds 20 Feb. 1772 and there were other conveyances by Isaac & Susannah, including one acre at the corner of Old York Road and Street Road 4 Dec. 1792 to Jonathan Thomas for 30 pounds and 55 perches in Warminster on Street Road 1 Apr. 1802 to Charles Terry for 12 pounds. When Isaac drew his will 4.24 or 28. 1802 he still had 135 acres which he devised to son Jonathan. Also mentioned were wife Susanna, daughters Mary and Agnes. The will of Susanna of Warminster Twp, widow, drawn 2.20.1814, codicil 10.31.1820, proved in Bucks Co. June 5, 1821, named the same three children, mother Mary Kirk, and six grandchildren, Martha and Agnes Walton, Susanna and Sarah Worthington, Mary and Sarah Harding. The three children:

352 Agnes b ab 1774 d 1851 m 1801 Hiram Worthington

353 Mary d 1861 m Henry Harding b ab 1776

354 Jonathan b 1779 d 1825 m 1803 Hannah Worthington b 1784 d 1823

117 SARAH WALTON (4), born 9.21.1731, died 6.22.1822, daughter of 39 Job Walton & Agnes Walmsley of Byberry Twp, Phila. Co., Pa., married 1st 6.12.1753 at Byberry appointed Mtg, Samuel Lloyd of Moorland, born Oct. 8, 1729, son of Thomas Lloyd & Mary Harker, married 2nd soon after Sep. 24, 1783, when they passed Horsham Mtg, Jacob Tomkins, born Jan. 6, 1737, died June 17, 1810, son of Robert Tomkins & Lydia Carrell. This is from meeting records, History of Byberry and Moreland, and the Robert Taylor Family. Sarah & Samuel passed Abington Mtg 5.28.1753 and 6.25.1753 were reported married. When she married Jacob Tomkins she was a widow with children. March 31, 1784 Jacob with wife Sarah and children Jacob, Elizabeth, Hannah, Mary and Martha removed from Horsham to Northern District Mtg in Phila. He had been clerk of Horsham Mtg from Aug. 29, 1782 until then, and had served as executor of many estates. His earlier wife was Elizabeth Thomas, born Sep. 9, 1737, died Apr. 11, 1781, daughter of Daniel Thomas Jr & Susannah Livezey. Sarah had no children by Jacob. Roberts-Walton Family Sketches gives seven children by Samuel as below, and says Sarah died July 8, 1804. However, there is among the Hettie Ann Walton Ms a very ancient writing, probably a page and part page torn from a bible, giving dates for children of Job Walton, brother of the above Sarah Walton Lloyd Tomkins, which says Sarah Tomkins is 79 years of age 2nd day of 12th mo 1810. This agrees exactly with her date of birth (O.S.) and shows she did not die in 1804. The seven children of Samuel & Sarah:

- 1 Sarah b 1755 d 2.20.1824 in her 69th year, m 12.20.1776 David Lukens or Lukens and was ancestor of the Huston family of Coatesville
- 2 Thomas
- 3 Samuel
- 4 Martha
- 5 Elizabeth
- 6 Rachel
- 7 Esther

118 JOB WALTON (4), born 27th 11th mo 1753, died 20th 9th mo 1807, son of 39 Job Walton & Agnes Walmsley of Byberry Twp, Phila. Co., Pa.,